

Skip THE LINE & GO!

You're Going To Love **YOUR NEW SEC³URE GO!**

because you'll never wait in line again. You've got instant and trusted access to over 11,000 locations of care around the world. Here's how you get started.

Download Apps

Go to the **App Store** or **Google Play** and download both of the **SEC³URE** apps. Make sure your mobile device has the most recent software updates.



SEC3URE



SEC3URE GO!

Enable Bluetooth

Verify **Bluetooth** is enabled on your mobile device.



Pair Badge

Open the **SEC³URE GO!** app. Select **Pair Badge** on the home screen and select the **SEC³URE GO!** ID displayed on the badge.



Enter Passcode

A **six-digit passcode** will appear on your **SEC³URE GO!** Enter the passcode on your mobile device.

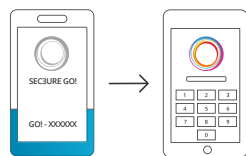

Get Connected

Your **SEC³URE GO!** will display **"Let's Get You Connected"** when pairing has been completed. That's it!



Visit the Facility

Check In with your **SEC³URE Mobile App**.
Transmit to transfer your visit info to **SEC³URE GO!**
Check Out with your **SEC³URE Mobile App**.